

ROAD DESIGN PLAN

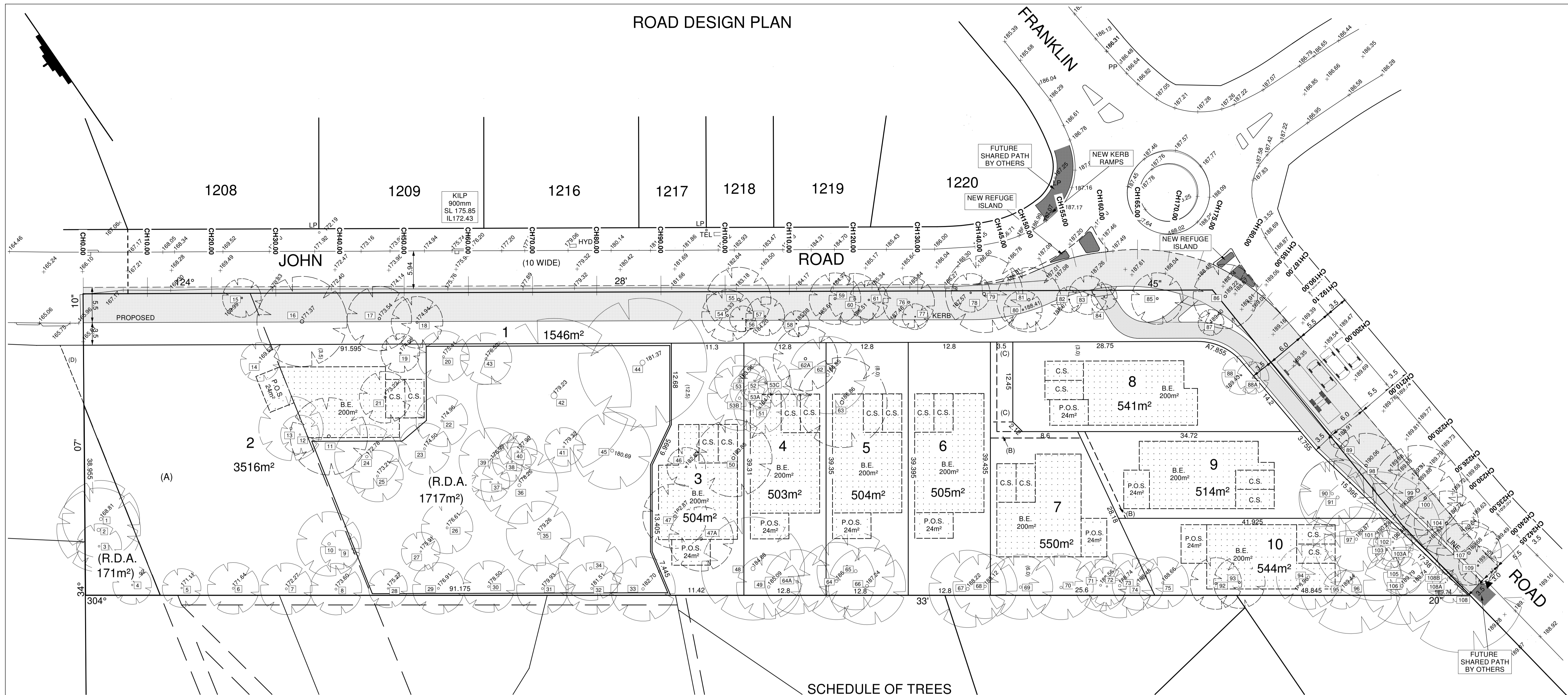

SCHEDULE OF TREES

No.	DESCRIPTION	DIA. (M)	SPREAD (M)	HEIGHT (M)	COND.
1	FOREST RED GUM	0.81	12	26	FAIR
2	FOREST RED GUM	0.55	13	25	FAIR
3	FOREST RED GUM	0.46	7	25	FAIR
4	TURPENTINE	0.25	6	9	GOOD
5	TURPENTINE	0.4	6	10	FAIR
6	TURPENTINE	0.28	8	7	GOOD
7	TURPENTINE	0.3	8	7	FAIR
8	TURPENTINE	0.32	8	7	FAIR
9	FOREST RED GUM	0.4	6	17	FAIR
10	FOREST RED GUM	0.39	10	19	FAIR
11	FOREST RED GUM	0.63	12	18	GOOD
12	FOREST RED GUM	0.48	6	18	FAIR
13	FOREST RED GUM	0.38	10	17	FAIR
14	SYDNEY BLUE GUM	0.4	6	15	GOOD
15	FOREST RED GUM	0.5	6	25	FAIR
16	FOREST RED GUM	0.7	14	25	FAIR
17	FOREST RED GUM	0.4	10	20	FAIR
18	SYDNEY BLUE GUM	0.5	8	20	FAIR
19	SYDNEY BLUE GUM	0.47	6	18	FAIR
20	FOREST RED GUM	0.43	8	17	GOOD
21	DEAD	0.76	-	-	POOR
22	FOREST RED GUM	0.44	8	18	GOOD
23	FOREST RED GUM	0.42	8	18	GOOD
24	FOREST RED GUM	0.46	10	20	FAIR
25	FOREST RED GUM	0.43	8	18	FAIR
26	FOREST RED GUM	0.85	8	25	GOOD
27	FOREST RED GUM	0.32	6.0	16	FAIR
28	FOREST RED GUM	0.25	6	9	GOOD
29	FOREST RED GUM	0.4	8	10	GOOD
30	FOREST RED GUM	0.44	8	11	GOOD
31	TURPENTINE	0.32	8	9	GOOD
32	TURPENTINE	0.42	8	10	GOOD
33	TURPENTINE	0.36	10	9	GOOD
34	FOREST RED GUM	0.43	10	23	GOOD
35	FOREST RED GUM	0.41	10	24	GOOD
36	FOREST RED GUM	0.67	12	25	GOOD
37	GREY BOX	0.18	6	7	FAIR
38	FOREST RED GUM	0.36	6	26	FAIR
39	GREY BOX	0.4	10	17	GOOD
40	FOREST RED GUM	0.41	6	16	FAIR
41	FOREST RED GUM	0.39	6	17	FAIR
42	FOREST RED GUM	1.3	24	26	FAIR
43	FOREST RED GUM	0.4	8	17	GOOD
44	FOREST RED GUM	0.72	20	23	FAIR
45	FOREST RED GUM	0.78	12	28	POOR
46	FOREST RED GUM	0.37	6	16	GOOD
47	FOREST RED GUM	0.52	10	22	GOOD
47A	CLARET ASH	0.24	10	10	GOOD
48	PEPPERCORN	0.33	16	16	FAIR
49	PAPERBARK	0.6	10	16	FAIR
50	EVERGREEN ASH	0.5	12	11	GOOD
51	FOREST RED GUM	0.5	8	19	GOOD
52	FOREST RED GUM	0.33	5	17	FAIR
53	FOREST RED GUM	0.4	8	18	FAIR
53A	FOREST RED GUM	0.3	6	18	FAIR
53B	COOK PINE	0.23	10	13	GOOD
53C	PAPERBARK	0.28	8	16	GOOD
54	TALLOWWOOD	0.3	8	20	FAIR
55	SPOTTED GUM	0.4	10	20	FAIR
56	TALLOWWOOD	0.3	4	20	FAIR
57	TALLOWWOOD	0.4	6	20	FAIR
58	RED IRONBARK	0.3	4	15	FAIR
59	TALLOWWOOD	0.4	8	20	FAIR
60	TALLOWWOOD	0.3	8	15	FAIR
61	FOREST RED GUM	0.4	6	20	FAIR
62	LEMONG SCENTED GUM	0.59	12	23	GOOD
62A	JACARANDA	0.18	10	9	GOOD
63	LEMONG SCENTED GUM	0.79	14	25	FAIR
64	FOREST RED GUM	0.6	12	21	GOOD
64A	SOUR GUM	0.19	10	7	FAIR
65	GOLDEN ELM	0.3	12	7	FAIR
66	TALLOWWOOD	0.69	12	20	GOOD
67	PAPERBARK	0.55	12	18	GOOD
68	PAPERBARK	0.45	10	16	GOOD
69	PAPERBARK	0.48	10	18	GOOD
70	PAPERBARK	0.45	10	17	GOOD
71	PAPERBARK	0.45	8	17	GOOD
72	PAPERBARK	0.23	6	13	GOOD
73	PAPERBARK	0.6	10	17	GOOD
74	PAPERBARK	0.3	8	14	FAIR
75	PAPERBARK	0.37	8	15	GOOD
76	WHITE SALLY WATTLE	0.4	8	20	FAIR
77	BLACKBUTT	0.3	4	20	FAIR
78	SPOTTED GUM	0.3	6	15	FAIR
79	SYDNEY BLUE GUM	0.5	12	20	FAIR
80	WHITE GUM	0.3	6	15	FAIR
81	FLOODED GUM	0.5	10	25	FAIR
82	WILLOW BOTTLEBRUSH	0.3	4	13	FAIR
83	SPOTTED GUM	0.4	6	15	FAIR
84	WILLOW BOTTLEBRUSH	0.3	4	7	FAIR
85	FOREST RED GUM	0.5	8	20	FAIR
86	FOREST RED GUM	0.7	10	30	FAIR
87	CYPRESS	0.5	4	15	FAIR
88	CYPRESS	0.38	6	16	GOOD
88A	GOLDEN ELM	0.18	5	7	FAIR
89	RED IRONBARK	0.3	3	12	FAIR
90	LEMONG SCENTED GUM	0.44	10	20	FAIR
91	LEMONG SCENTED GUM	0.25	12	16	FAIR
92	PAPERBARK	0.32	8	16	GOOD
93	PAPERBARK	0.41	8	15	FAIR
94	FIDDLEWOOD	0.26	10	14	GOOD
95	TURPENTINE	0.4	6	14	FAIR
96	SYDNEY BLUE GUM	0.75	16	18	POOR
97	EVERGREEN ASH	0.3	10	9	FAIR
98	TALLOWWOOD	0.4	10	15	FAIR
99	YELLOW BLOODWOOD	0.8	14	25	FAIR
100	YELLOW BLOODWOOD	0.6	10	25	FAIR
101	FOREST RED GUM	0.65	20	28	GOOD
102	TURPENTINE	0.2	6	10	GOOD
103	LEMONG SCENTED GUM	0.19	6	15	FAIR
103A	LEMONG SCENTED GUM	0.22	6	17	FAIR
104	YELLOW BLOODWOOD	0.5	10	25	FAIR
105	LEMONG SCENTED GUM	0.28	6	25	FAIR
106	GREY IRONBARK	0.35	12	17	GOOD
107	YELLOW BLOODWOOD	0.5	10	25	FAIR
108	FLOODED GUM	0.88	20	30	GOOD
108A	LEMONG SCENTED GUM	0.18	4	16	FAIR
108B	LEMONG SCENTED GUM	0.16	4	17	FAIR
109	WHITE SALLY WATTLE	0.3	6	10	FAIR

R.D.A. DENOTES PROPOSED RESTRICTED DEVELOPMENT AREA

NB: TOTAL AREA OF ROAD WIDENING TO BE SOLD TO HORNSBY SHIRE COUNCIL UNDER V.P.A. (LOT 1) 1546m²

TOTAL SITE AREA - 9228m²

- (A) EASEMENT FOR TRANSMISSION LINE 30.48 WIDE (D.P. 444349) VIDE J5360
- (B) PROPOSED EASEMENT TO DRAIN WATER 1 WIDE
- (C) PROPOSED RIGHT OF ACCESS & EASEMENT TO DRAIN WATER 3.5 WIDE
- (D) EASEMENT TO DRAIN WATER VARIABLE WIDTH (D.P.828271)

Notes:-

- This Detail Survey is not a "survey" as defined by the Surveying & Spatial Information Regulation 2012. If any further construction is planned, it would be advisable that boundaries be marked on the ground prior to construction.
- No investigation has been made of underground services on and adjacent to the subject land. Please contact the necessary authority prior to commencing works
- Tree positions and sizes shown are estimated.
- This drawing is subject to copyright. It must not be produced in whole or part without prior written consent of P. S. GRAHAM & ASSOCIATES. PTY. LTD

P. S. GRAHAM & ASSOCIATES PTY LTD

REGISTERED SURVEYORS CONSULTING ENGINEERS TOWN PLANNERS
 OFFICE 4, GROUND FLOOR PROJECT MANAGEMENT (02) 9484 5121
 295 - 299 PENNANT HILLS ROAD ALL CORRESPONDENCE TO web: www.psgraham.com.au
 THORNLEIGH NSW 2120 P.O. BOX 263 BEECROFT NSW 2119 email: ps@psgraham.com.au

REVISED PLAN OF PROPOSED SUBDIVISION (DA 1146/2020)
 FOR LOT 18 IN D.P. 16975
 90-92 FRANKLIN ROAD - CHERRYBROOK

LGA : HORNSBY
 DATUM: A.H.D.

DATE: 22-08-2022
 CAD: S15696A

NOTE:
 DIMENSIONS AND AREAS ARE
 SUBJECT TO FINAL SURVEY



SCALE: 1:300 (A1)
 SHEET 3 OF 15 REV. B
 REF.No. S.15696B